

DESCRIPTION

- Component construction with various finishes identified by suffix
- Handshower with Magnetix™ docking
- 60" hose included
- Assembled with two check valves for backflow prevention
- Adjustable bracket

OPERATION

- Six function handshower
- Wall bracket rotates to adjust angle of handshower

FLOW

- Flow is limited to 1.75 gpm (6.7 L/min) max.

STANDARDS

- Designed and manufactured to comply with the applicable requirements of WaterSense®, ASME A112.18.1/CSA B-125.1, ASSE 1014 and all applicable specifications referenced therein
- Meets WaterSense® criteria

WARRANTY

- Lifetime limited warranty against leaks, drips and finish defects to the original homeowner
- 10 year limited warranty when used in a multifamily installation
- 5 year limited warranty when used in a commercial installation

Visit www.moen.com/support for complete details and limitations

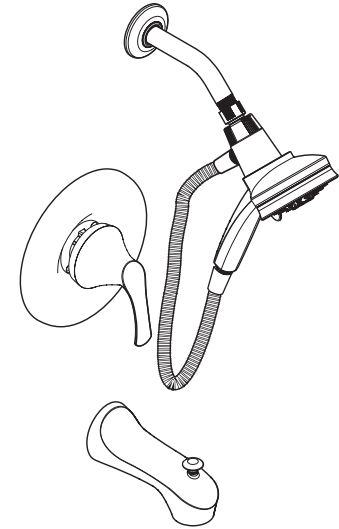

Darcy™ Posi-Temp® Single Handle Tub/Shower with Magnetix™ Handheld Shower

Models: 82560 series

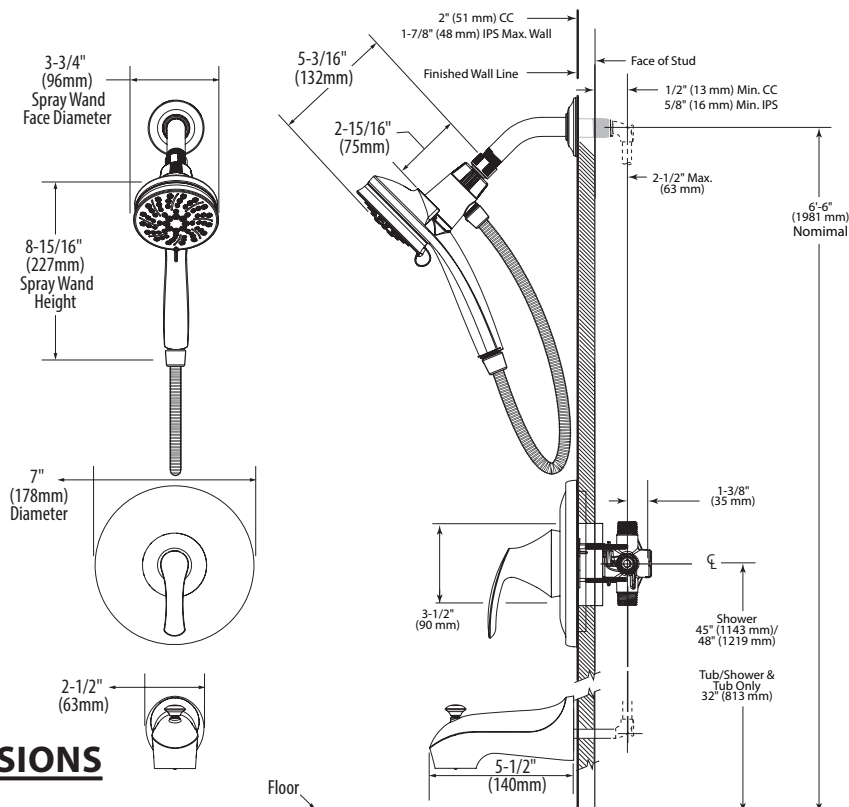

CRITICAL DIMENSIONS

(DO NOT SCALE)

Floor